

Design and fabricate your own stackable spinning top.

1. Click the **Classes** tab

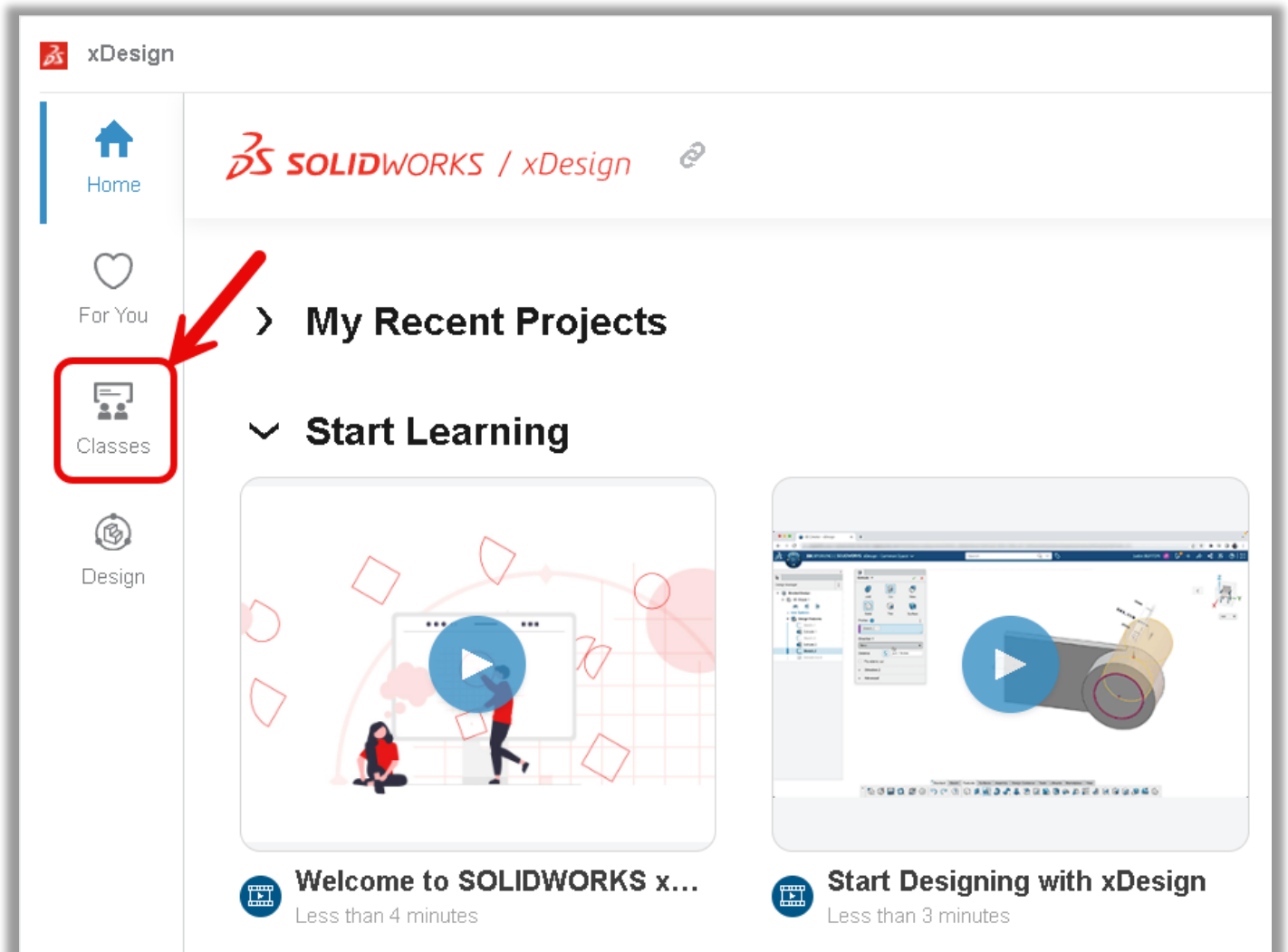

2. Hover over the PDF tile

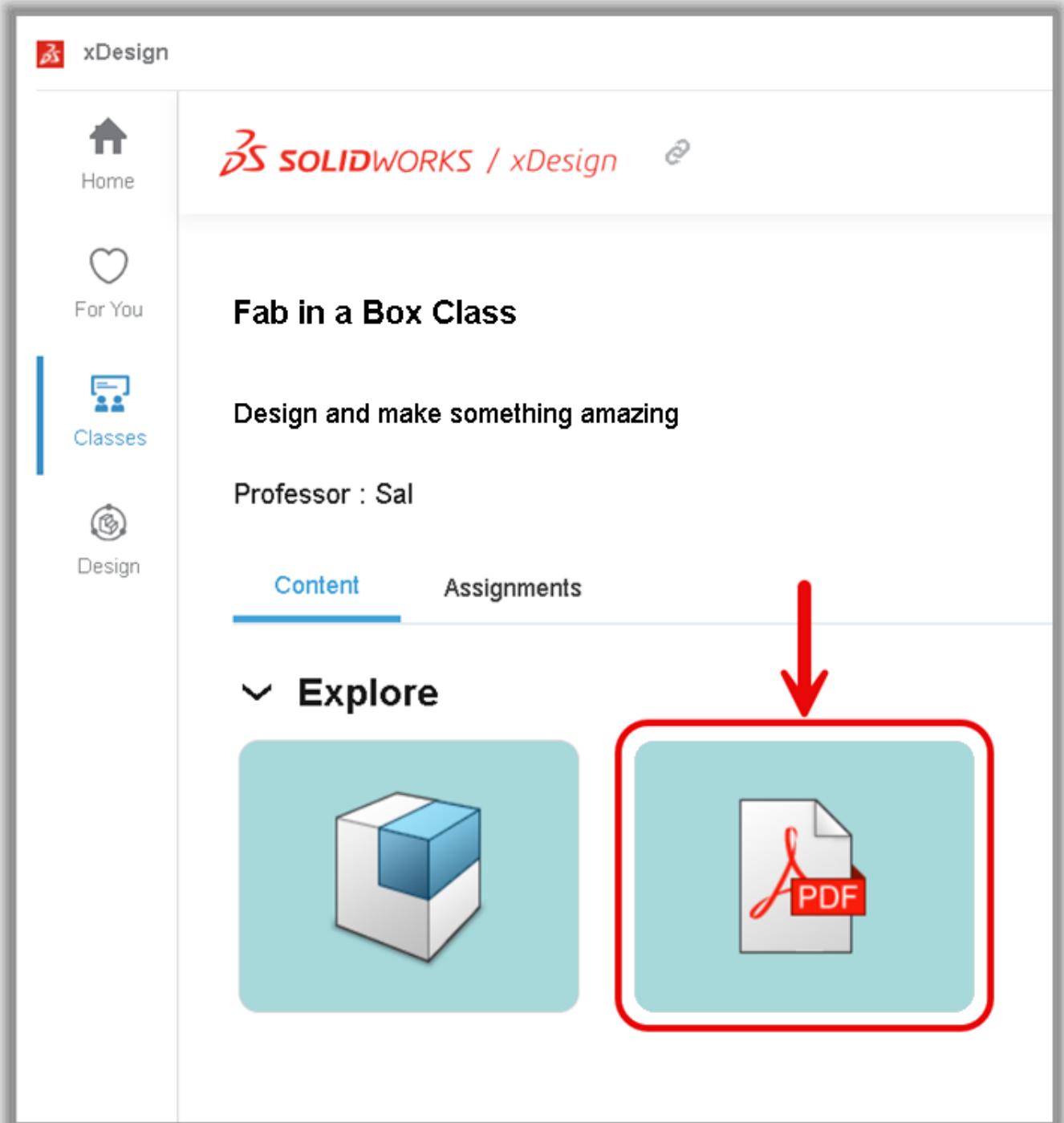

3. Click **OPEN**

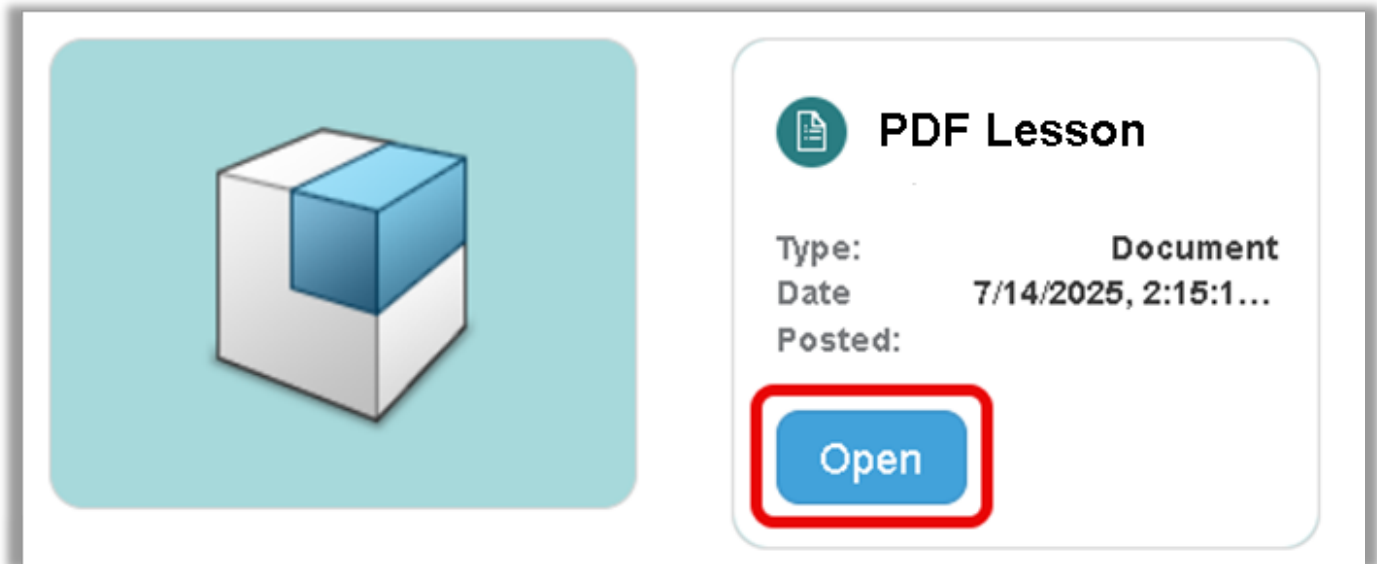

4. Click the **+Create** button at the top of the xDesign “Home” screen



5. [1] Give the design a unique name, [2] select your classes name as the location, and then [3] click **OK**

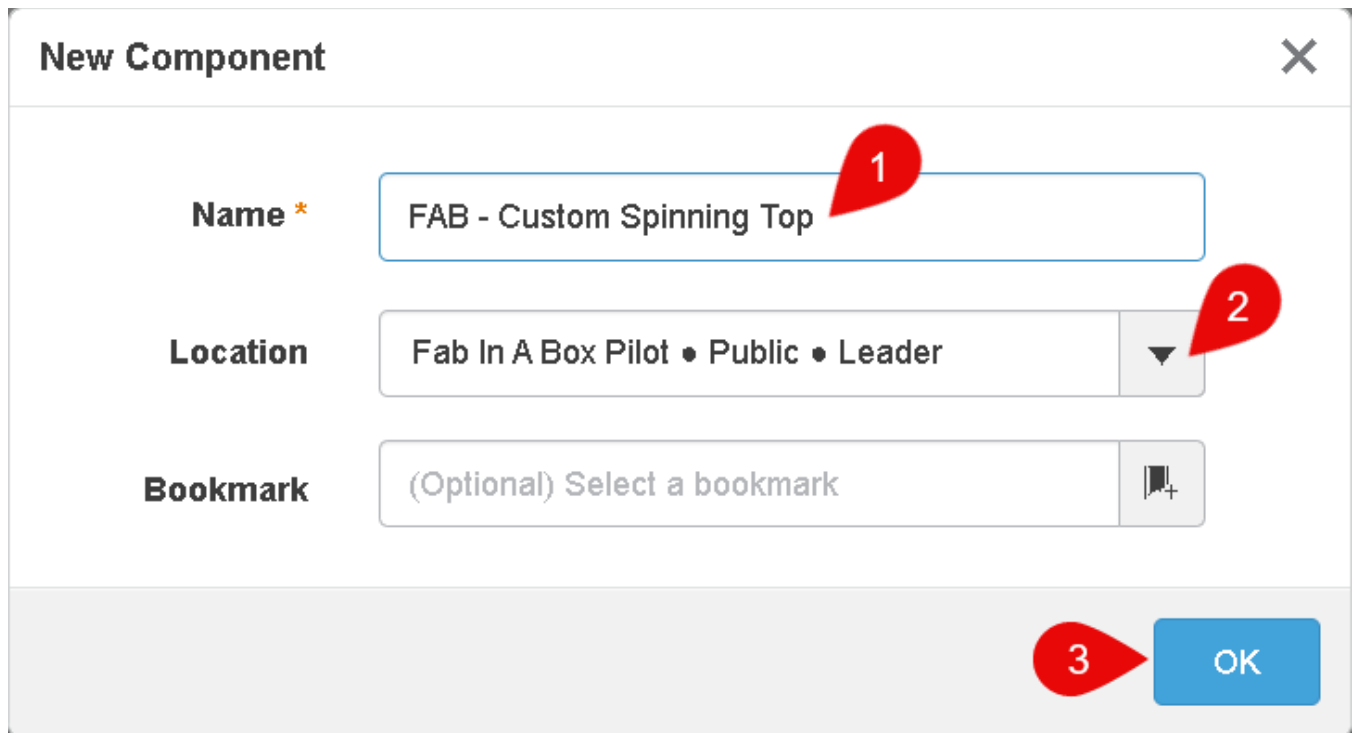

The image shows a 'New Component' dialog box with three main input fields and an 'OK' button. Red callout bubbles with numbers 1, 2, and 3 point to the Name field, the Location dropdown, and the OK button respectively.

New Component [X]

Name * FAB - Custom Spinning Top

Location Fab In A Box Pilot • Public • Leader ▼

Bookmark (Optional) Select a bookmark [Bookmark Icon]

3 [OK]

6. Use this blank template to model a stackable spinning top design of your own.
7. When you're done, click "Save" on the Action Bar to save your custom spinning top

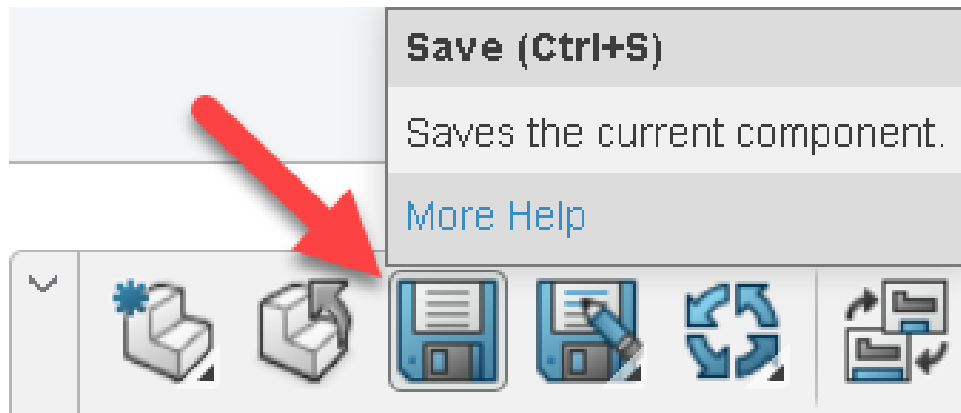

FABRICATE YOUR STACKABLE SPINNING TOP

8. [1] Click the flyout corner under the Save As command on the Standard tab of the Action Bar, and then [2] click the **Export** command

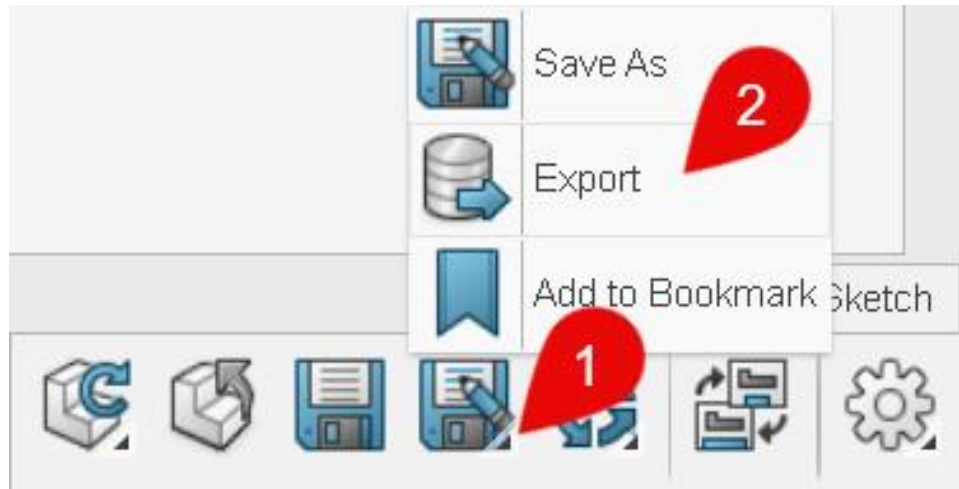

9. Click the Location folder button

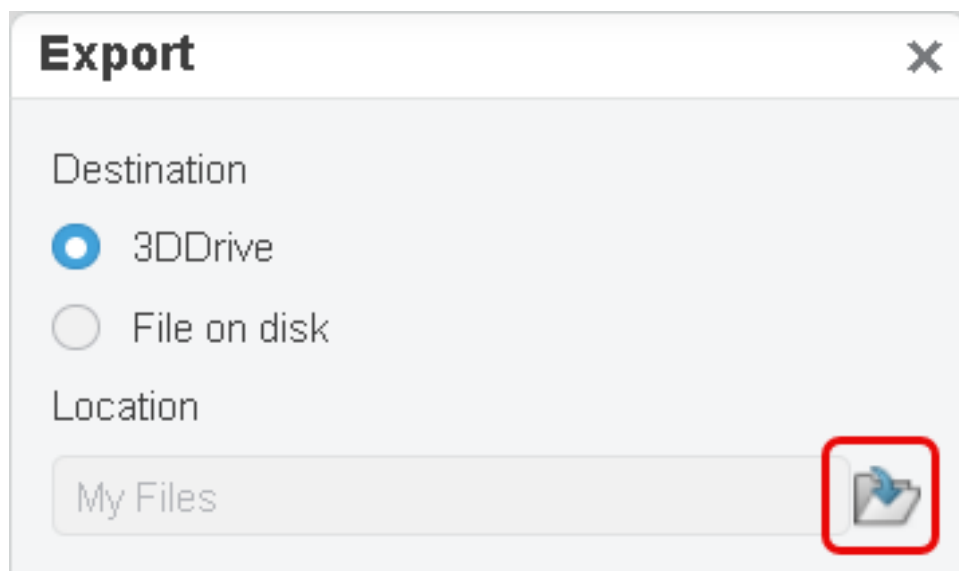

10. [1] Select the folder your instructor told you to use to save your files, then [2] click **OK**

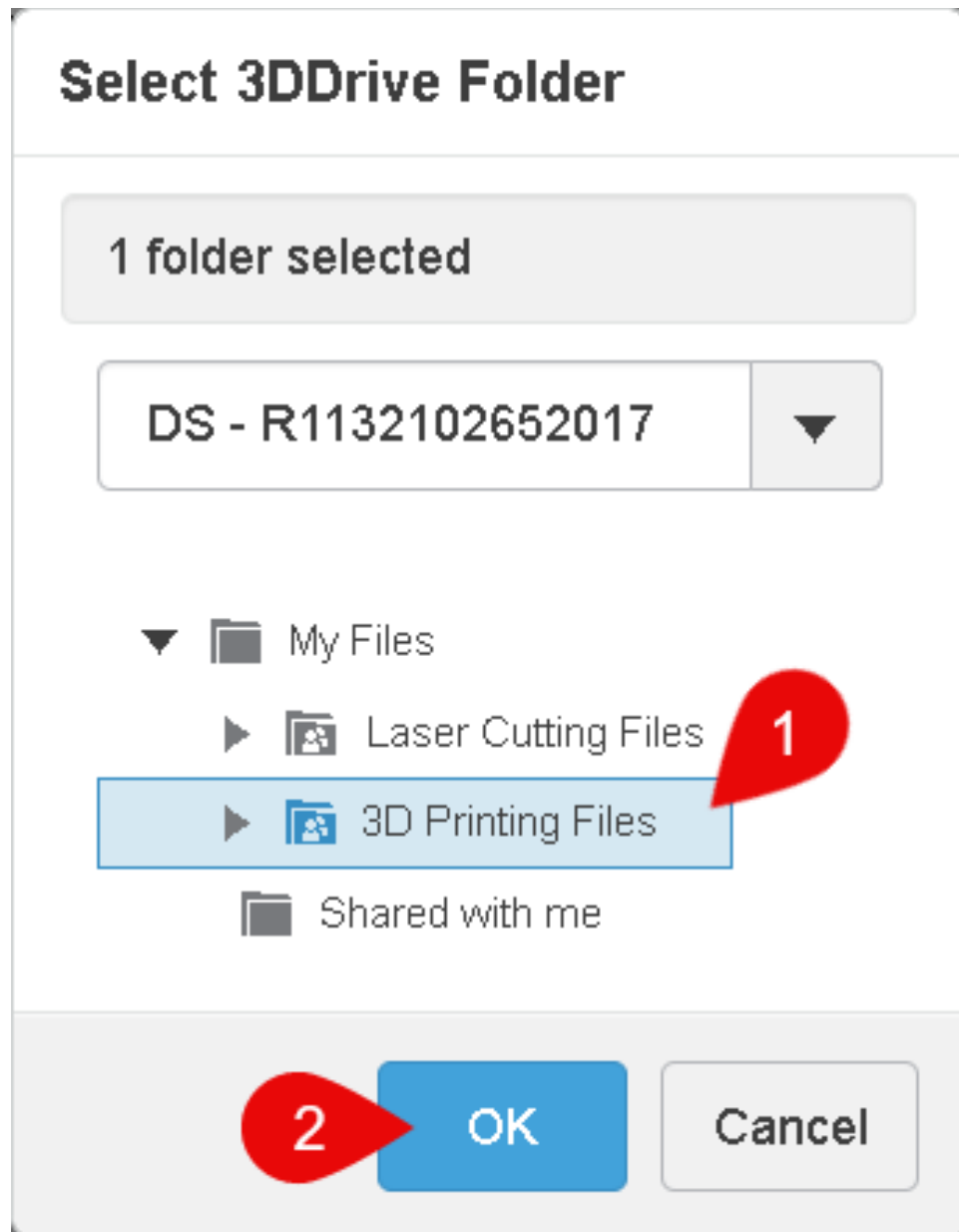

11. [1] Give the file a unique name, [2] change the format to “**STEP AP214**”, and then [3] click **Export**

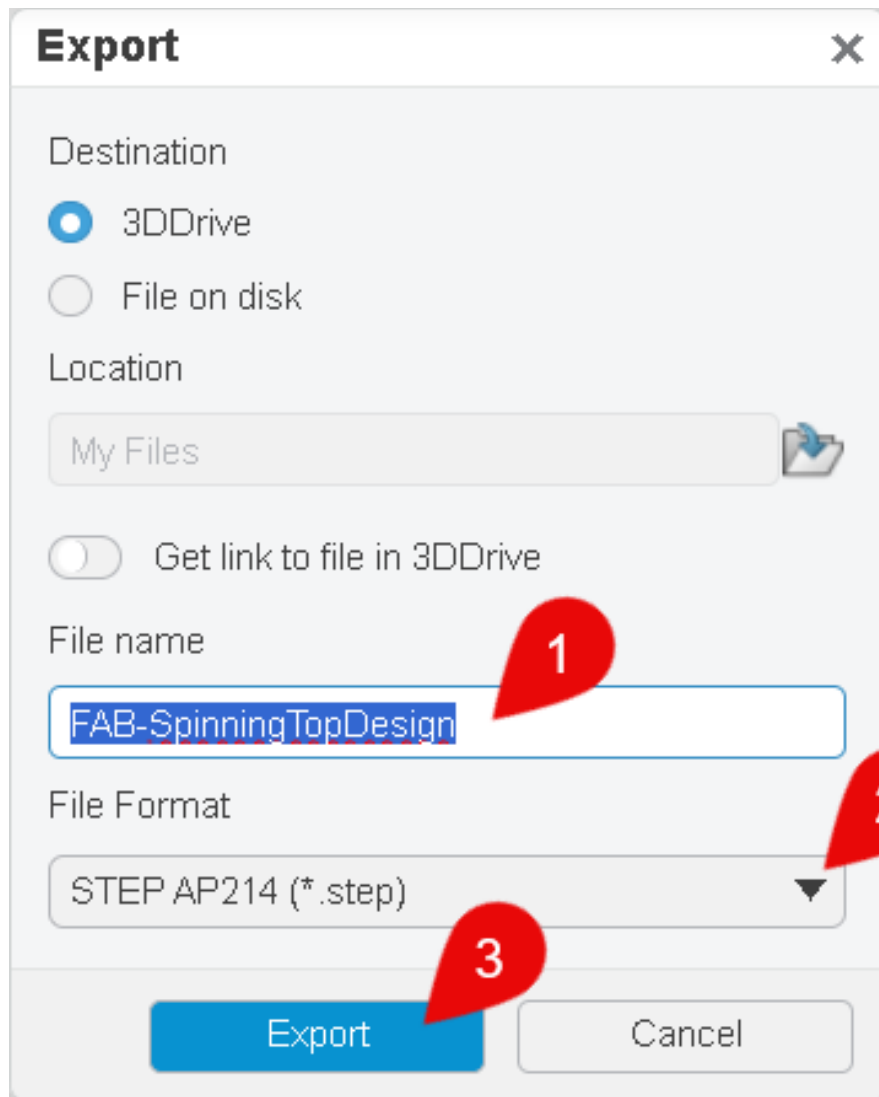

Congratulations!

You're ready to 3D print your top!

See your teacher for further instruction!